

MR. BASIC

Manual: Model TR-3

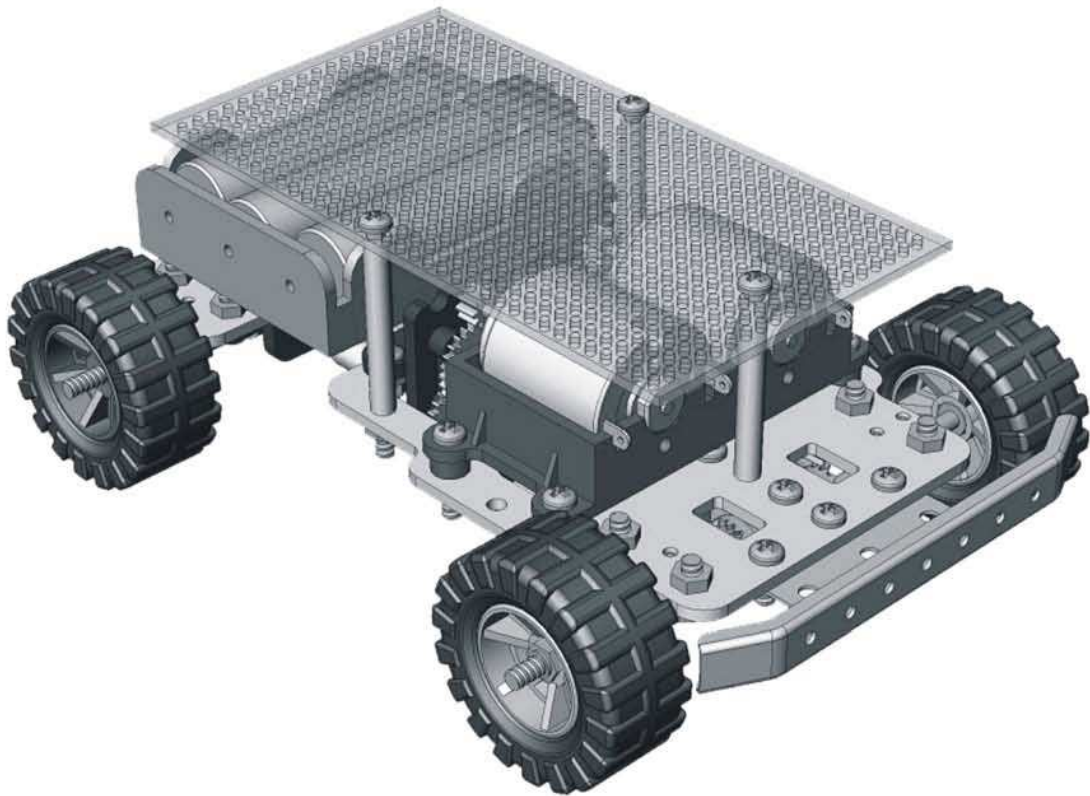

Copyright poverty:

This description is protected by the laws of copyright, any partial or total reproduction of the contents is prohibited without prior written authorization of the manufacturer: AREXX Engineering-Zwolle(NL).

The manufacturer and distributor cannot be held responsible for any damages occurred by mishandling, mounting mistakes or misuse due to non-respect of the instructions contained in this manual.



Manufacturer:
DAGU Hi-Tech Electronic Co., LTD
WWW. AREXX.COM.CN



European Importer:
AREXX Engineering
ZWOLLE, HOLLAND

© DAGU CHINA

Address:NO.4-107/108 HengXing Street, HengHai Rd, South District, ZhongShan City of GuangDong China

TEL:0760-88811951

<http://www.arexx.com.cn>

E-mail:info@arexx.com.cn

PRODUCT DESCRIPTION

Thanks for selecting of our product Mr. Basic, which provides you with a reliable expandable platform and it is a good partner for DO-IT-YOURSELF.

PRODUCT FEATURES

1. With aluminum alloy chassis, strong and durable.
 2. With two motor260s and one 4.5V voltage independent driver, strong and powerful.
 3. With rational structure, easy to expandable.
 4. Independent parts packaging provides you an absolute pleasure at DIY.
- Build it now! Realize your dream, we are looking forward to your masterpiece..



Warning:

- No refund is possible after having opened the components bags (Please check contact first).
- Prior to the assembly read the manual thoroughly.
- Be careful when using tools.
- Keep this kit away from young children during construction and operation. (They might get hurt by the tools or swallow small components).
- Observe the correct polarity of the battery.
- Keep the battery dry. When the Mr. Basic gets wet DO NOT USE.
- Let the Mr. Basic dry until completely dry.
- If it is not used for a long time, remove the battery.

Necessary Tools:

Before you start assembling we suggest you first read the manual thoroughly. Please follow the assembling instructions exactly to avoid problems. If you work accurately and follow the instructions in this manual exactly you will immediately install a complete Mr. Basic.

Before you start you must prepare the tools as follow:



HEX

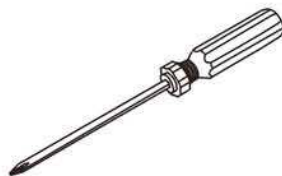

PHILLIPS CREW DRIVER

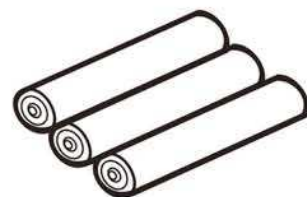

AA BATTERY

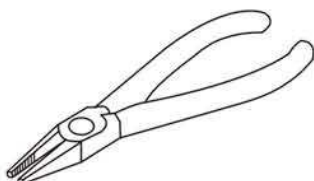

FLAT NOSE PLIERS



IRON SOLDER

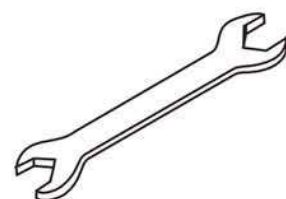

HEX SPANNER

List of components:

<p>1</p> <p>Motor gear (T10, Hole1.9) 2 pcs</p>	<p>2</p> <p>Double-pinion (T30+10, Hole2.4) +axis (Diameter2.5, L18) 2 pcs</p>	<p>3</p> <p>Motor gear (T10, Hole2.4) +axis (Diameter2.5 L24) 4 pcs</p>	<p>4</p> <p>Single-pinion (T36, Hole2.4) +axis (Diameter2.5, L45) 2 pcs</p>	<p>5</p> <p>Axis joint device 4 pcs</p>
<p>6</p> <p>Kimi screw 8 pcs</p>	<p>7</p> <p>Front axle (Diameter3, L 44, One end 10, Thread M3) + crown gear (T20, Hole2.9) 2 pcs</p>	<p>8</p> <p>Rear axle (Diameter3, L 44, One end 10, Thread M3) + crown gear (T20, Hole2.9) 2 pcs</p>	<p>9</p> <p>Motor260 2 pcs</p>	
<p>10</p> <p>Motor260 holder 1 pc</p>	<p>11</p> <p>Chassis 1 pc</p>	<p>12</p> <p>Decelerated pinion chassis 2 pcs</p>	<p>13</p> <p>Big wheel 4 pcs</p>	
<p>14</p> <p>Large rubber wheel 4 pcs</p>	<p>15</p> <p>Rear axle shaft fixer1 1 pc</p>	<p>16</p> <p>Rear axle shaft fixer2 4 pcs</p>	<p>17</p> <p>Bumper board 1 pc</p>	
<p>18</p> <p>Battery holder 1 pc</p>	<p>19</p> <p>Nut M3 37 pcs</p>	<p>20</p> <p>Front axle shift metal fixer 1 pc</p>	<p>21</p> <p>Motor self-tapping screw (M2.3*6)/(M2.6*6) 2 pcs 2 pcs</p>	
<p>22</p> <p>Copper tube (outer4 inner3 L6) 2 pcs</p>	<p>23</p> <p>Copper tube (outer4 inner3 L12) 4 pcs</p>	<p>24</p> <p>Copper tube (outer4 inner3 L30) 3 pcs</p>	<p>25</p> <p>PCB 1 pc</p>	

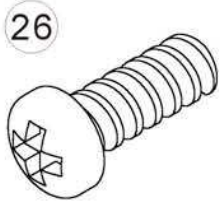

Screw M3*8 20 pcs

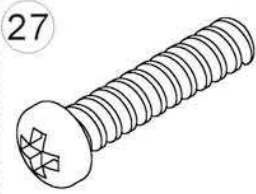

Screw M3*12 4 pcs

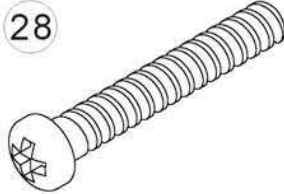

Grub screw M3*20 2 pcs

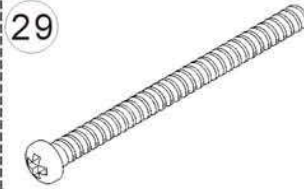

Screw M3*40 3 pcs

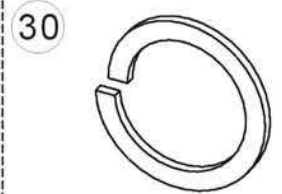

M3 spring washer 4 pcs

Instructions mechanical assembly:

STEP.1 Fix the bumper board

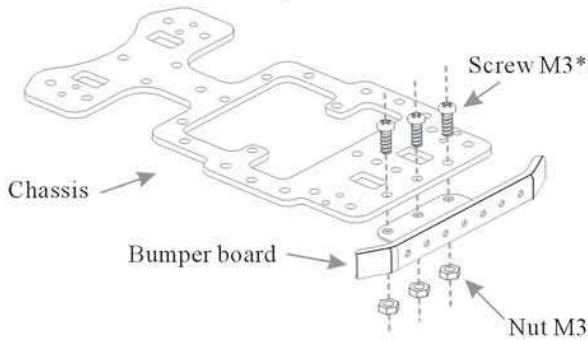

STEP.2 Assembly of decelerated pinion chassis (Please assemble in number order)

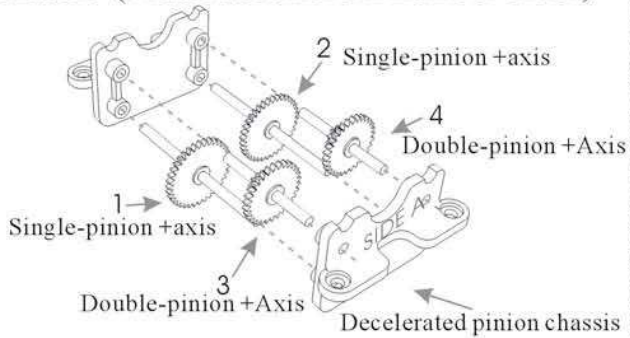

STEP.3-4 Install and fix the decelerated pinion chassis

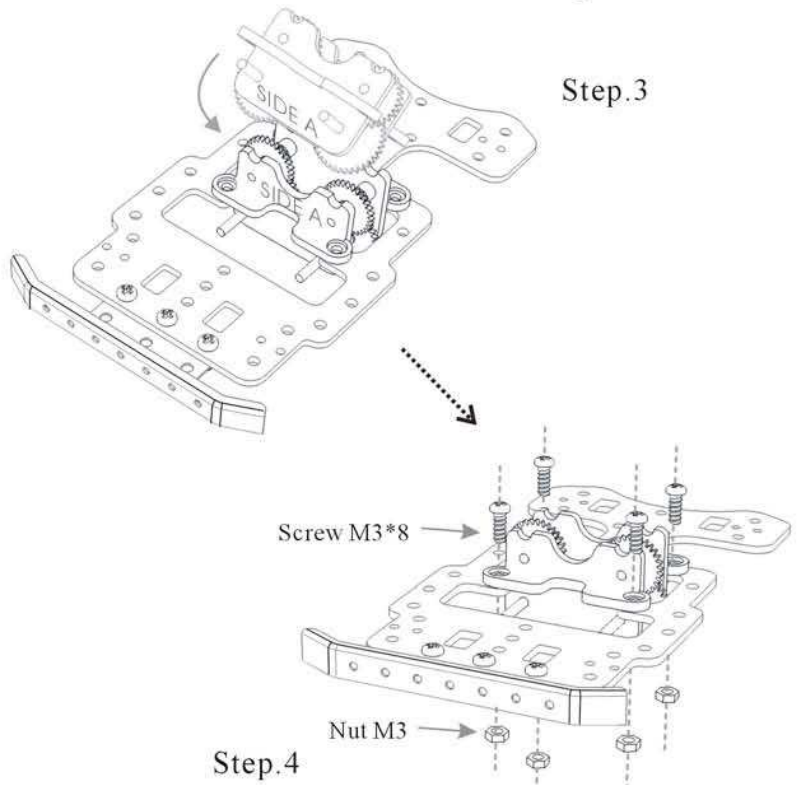

STEP.5 Install the rear axis fixing I

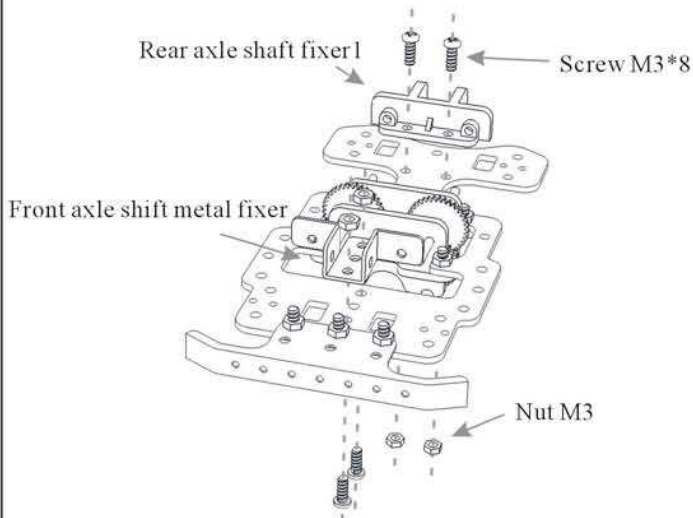

STEP.6 Install the axis joint device (Please assemble in number order)

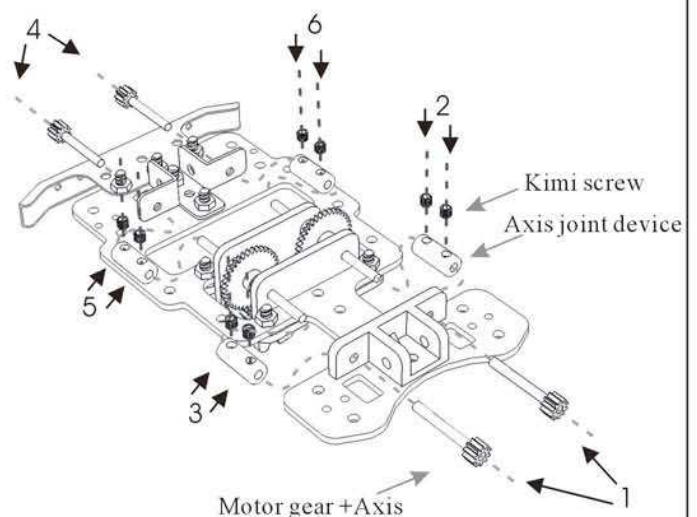

STEP.7 Install the rear axis fixing2 and rear axle shaft

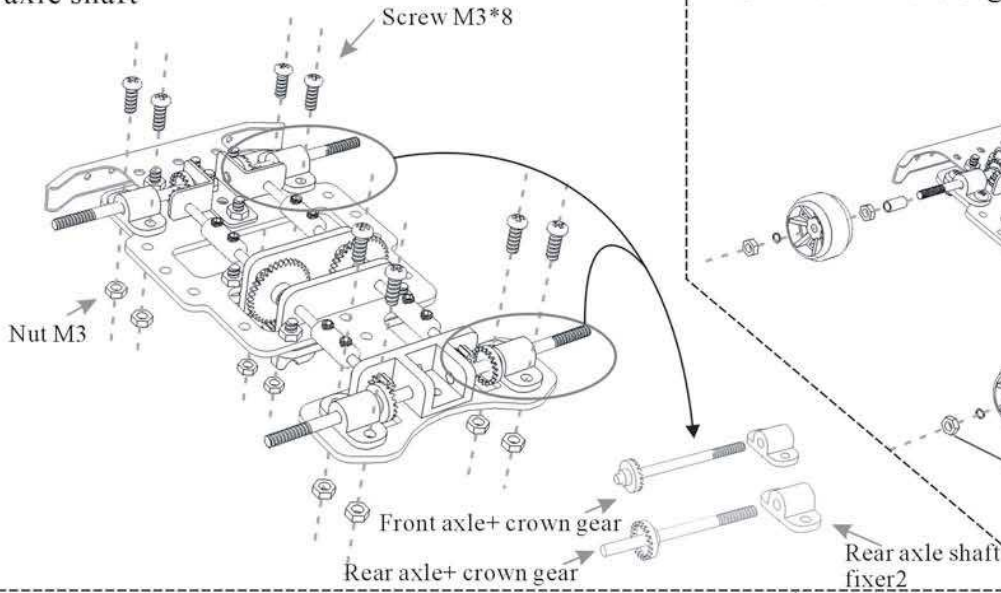

STEP.8 Fix the big wheel

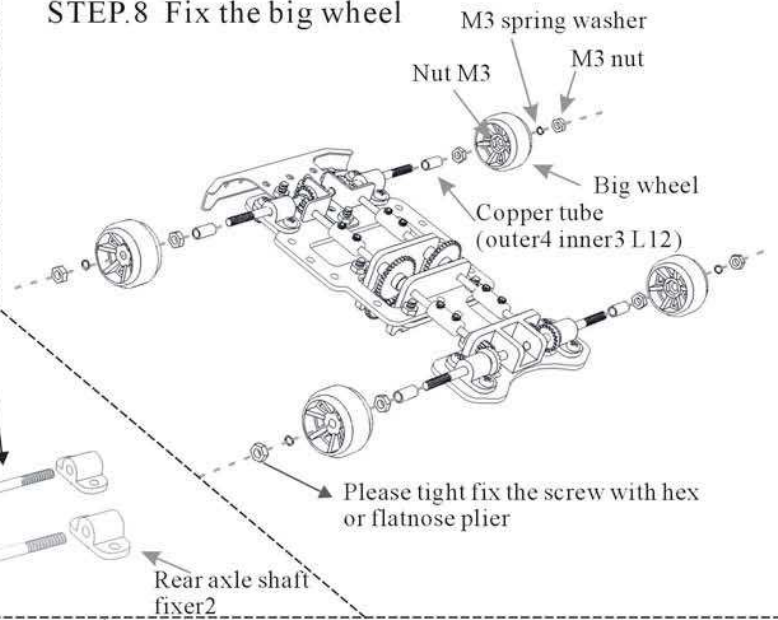

STEP.9 Install the big rubber wheel

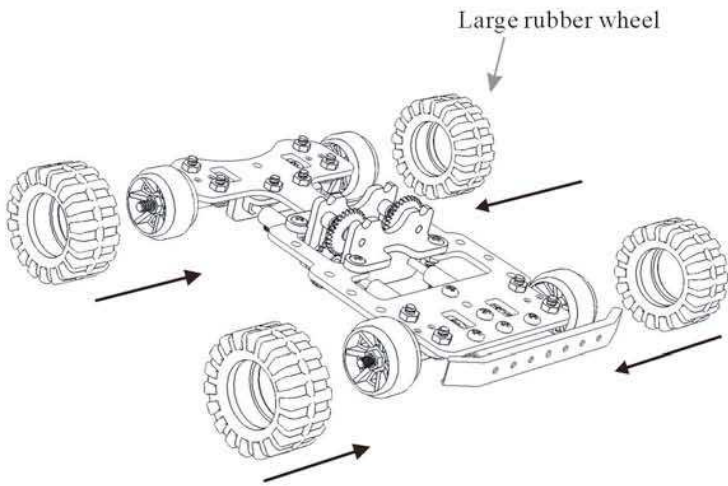

STEP. 10 Fix the motor (Please assemble in number order)

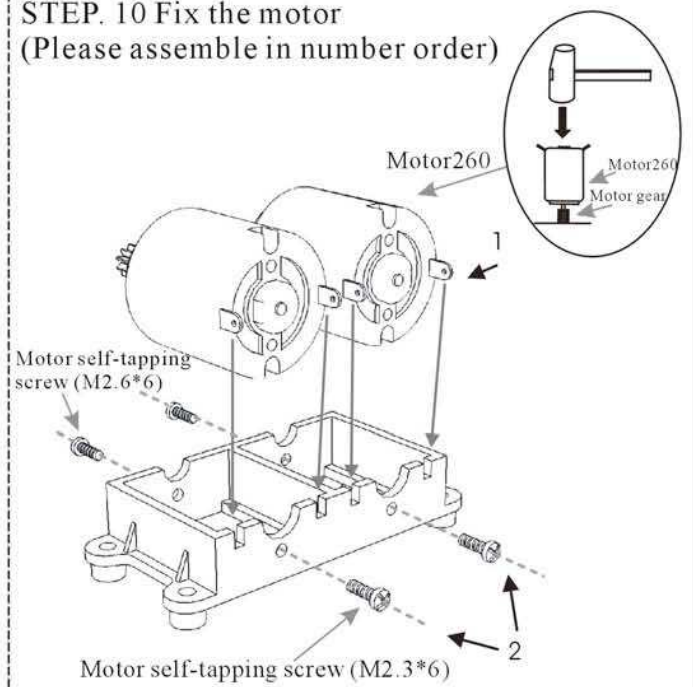

STEP.11 Install the motor

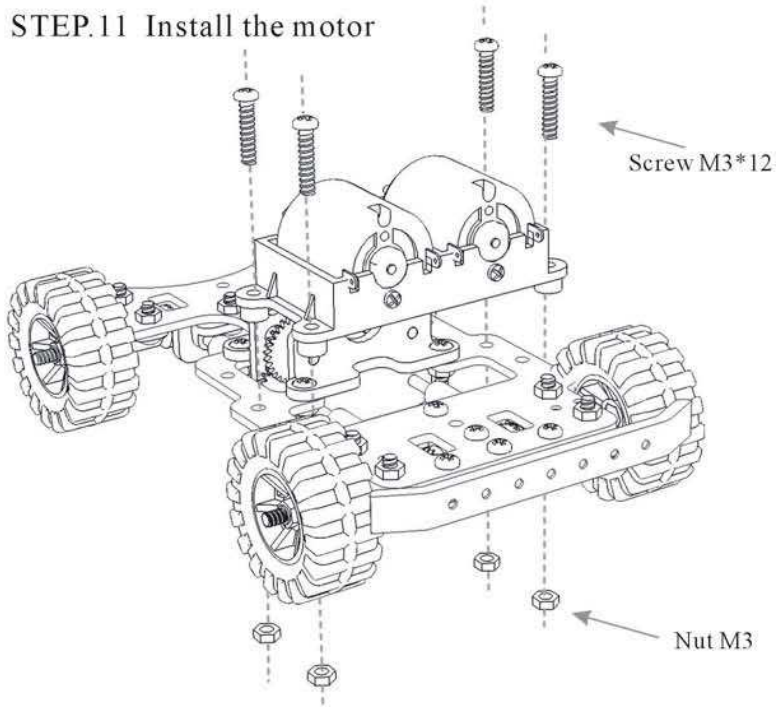

STEP.12 Fix the battery holder

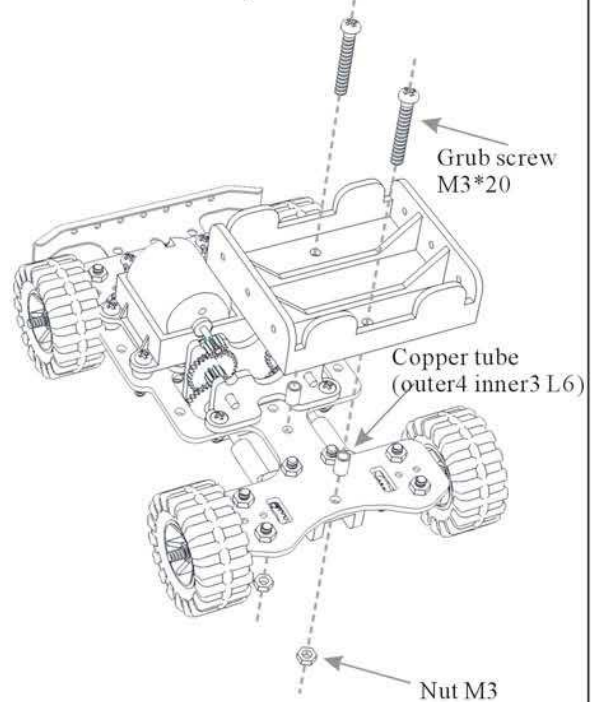

STEP.13 Fix the PCB

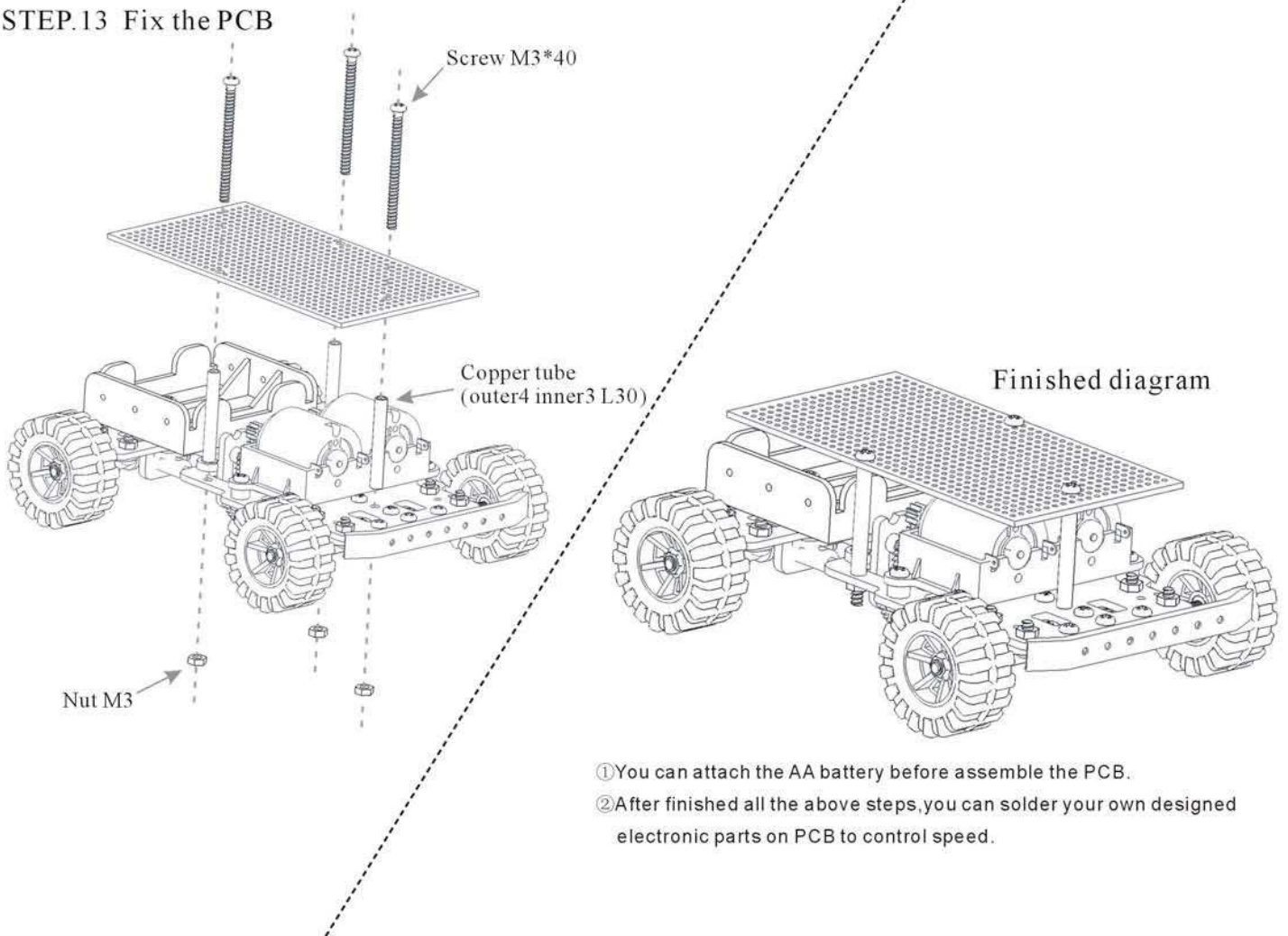

Trouble shooting:

Problems	Solutions
<p>The motors will not spin after being switched on</p>	<ul style="list-style-type: none"> • Check the circuit: Is it turn-off or connected correctly?(beware of shorting) • Check all components, see if they are assembled correctly and partial spinning parts are chocked. • Check the gears. (Please settle it immediately, this problem may overheat the motor and/or battery, which will lead to damage to your model.)
<p>Noisy after starting</p>	<ul style="list-style-type: none"> • Check all screws and nuts: Are they tight and correctly fitted? • Check the gears. • Check the wire and other components, do not touch the moving parts?